

1999. Design contest showing appeal

By **CHERI BENTRUP**
STAFF WRITER

It's been just a few weeks since registration began for the nationwide contest to design Wheeling's Millennium Plaza, and already 90 registrants have expressed some interest in the project.

In addition to Millennium Plaza, located on the northeast corner of Dundee Road and Milwaukee Avenue, the contest also seeks design ideas for the southeast and northwest corners of the intersection. It is anticipated the design ultimately chosen will be incorporated along the length of Milwaukee Avenue.

The contest, being organized by Design Competition Services of Milwaukee, is part of the village's plan to improve the appearance of Wheeling's thoroughfares. Landscaping the three corners with the winning design is expected to coincide with construction of One Milwaukee Place, a mixed residential and commercial development planned for the northwest corner of Milwaukee and Dundee.

"We're hoping for at least a couple of hundred of registrants," said David Phillips, chairman of the Millennium



WHEELING
RESTAURANT
ROW

SEE ALL
AS YOU
GO



The Restaurant New Design Theme is based on introducing an identity to the town by using culinary utensils as architectural elements. This presentation emphasizes the utilization of transferable components that are identified with the Wheeling Theme and placed throughout the town in a landscape indigenous to Cook County.

The solution calls for the use of earth mounds to act as buffers from motor vehicles and pedestrian/people paths. Local trees like Maples, Asters, Hickory, Dogwood, Willows, and Oaks are placed to soften the relationship between pedestrian and motorized traffic, and develop sound and visual control factors for transformation into a popular pedestrian traffic promenade. A variety of tall grasses and grain flowers are used for erosion control and identity with the area's geographic past.

The utensils used as examples are a spoon as a bench and wild flower planter, wine corkscrew as bus stop shelter, salt and pepper shakers as rubbish management containers. Also used is an ice cream scoop as telephone stand, kitchen utensils as kids' playground, soup bowl as a new amphitheater for people to gather which is surrounded by soupspoon lighting, etc. The total solution is marrying the natural area habitat and the restaurant gadget into a fun and easily identifiable solution for the new millennium gateway for the Village of Wheeling.

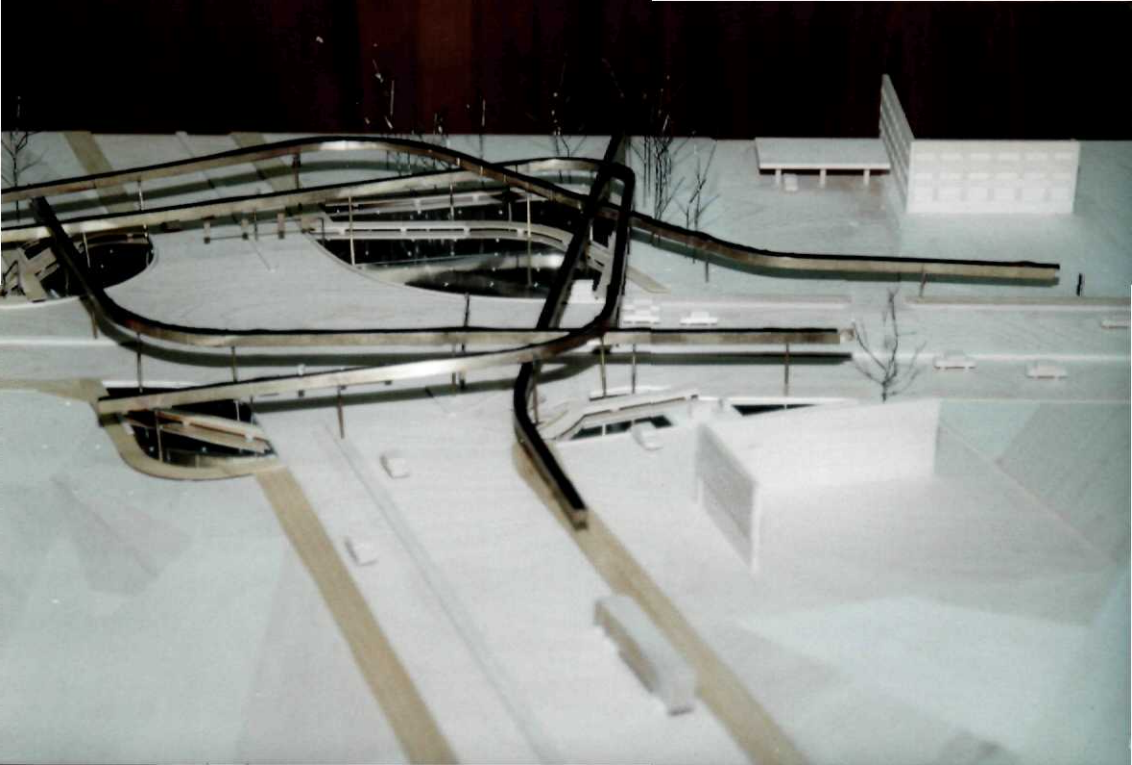



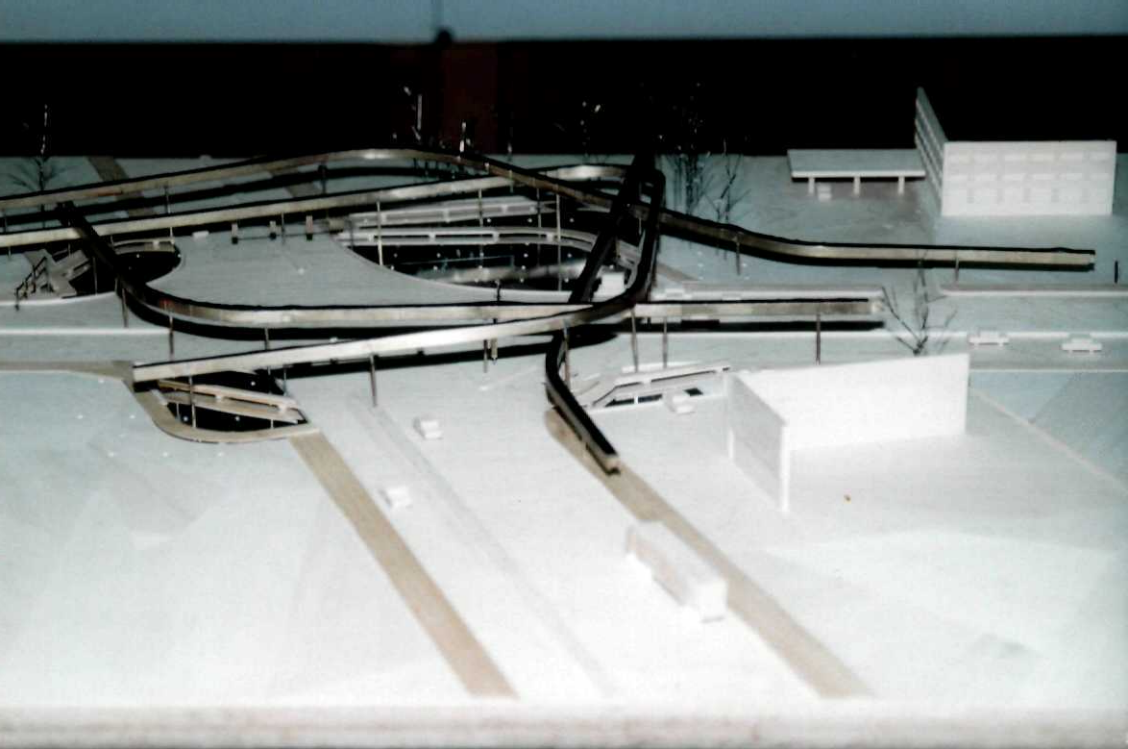



MILLENNIUM PLAZA @ THE CROSSROADS

WHEELING 2000

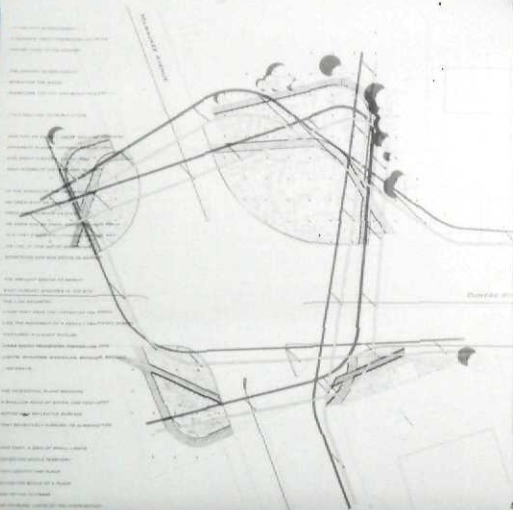

FIRST PHASE



SECOND PHASE



DESIGN THEMES AND COMPONENTS

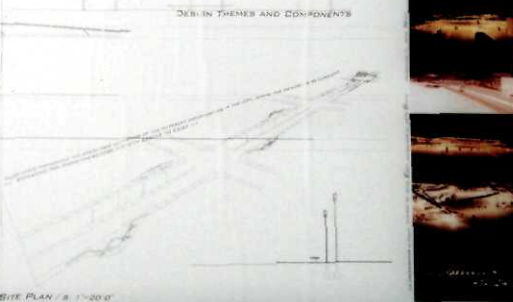

SITE PLAN / S 1"=20' 0"



TEA CUP FOUNTAIN



CORK SCREW BUS STOP



STEAK FORK FLAG POLE

ICE CREAM SCOOP PUBLIC PHONE

TRANSFERABLE
COMPONENTS



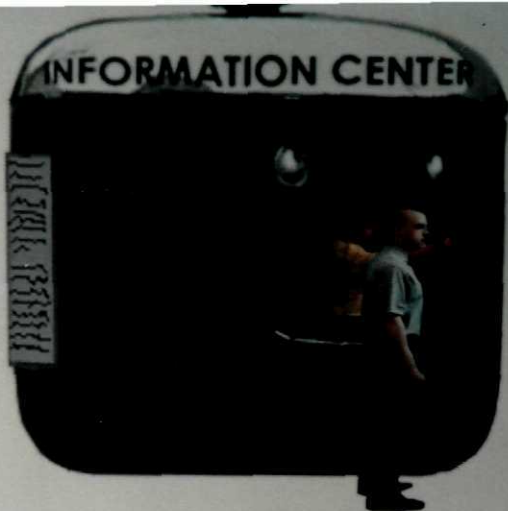

SOUP POT INFORMATION KIOSK

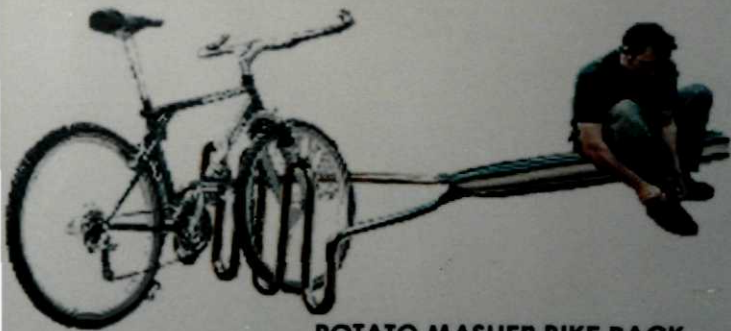

POTATO MASHER BIKE RACK



time tapestry

re-marking on a common ground



The designers sought inspiration from the historic street layout of the settlement from the 1930s. The grid layout is the result of a series of small-scale interventions, which the designers believe leads to a better urban form.

The designers sought inspiration from the historic street layout of the settlement from the 1930s. The grid layout is the result of a series of small-scale interventions, which the designers believe leads to a better urban form.

The designers sought inspiration from the historic street layout of the settlement from the 1930s. The grid layout is the result of a series of small-scale interventions, which the designers believe leads to a better urban form.

The designers sought inspiration from the historic street layout of the settlement from the 1930s. The grid layout is the result of a series of small-scale interventions, which the designers believe leads to a better urban form.

The designers sought inspiration from the historic street layout of the settlement from the 1930s. The grid layout is the result of a series of small-scale interventions, which the designers believe leads to a better urban form.

- grid**
The grid is a key element of the design, providing a structure for the settlement. It is a result of a series of small-scale interventions, which the designers believe leads to a better urban form.
- multifunction**
The design is multifunctional, providing a range of uses for the settlement. This includes residential, commercial, and public spaces.
- plots**
The design is based on a grid of plots, which are of varying sizes and shapes. This allows for a mix of building types and uses.
- paths**
The design includes a network of paths, providing a means of movement between different parts of the settlement.
- movement**
The design is focused on movement, providing a range of options for how people can move through the settlement.
- water**
The design includes a water collection system, which is a key element of the settlement's infrastructure.
- collection**
The design includes a collection system, which is a key element of the settlement's infrastructure.
- rooms**
The design includes a range of room types, providing a variety of living and working spaces.
- homestead**
The design includes a homestead, which is a key element of the settlement's infrastructure.

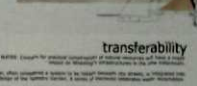
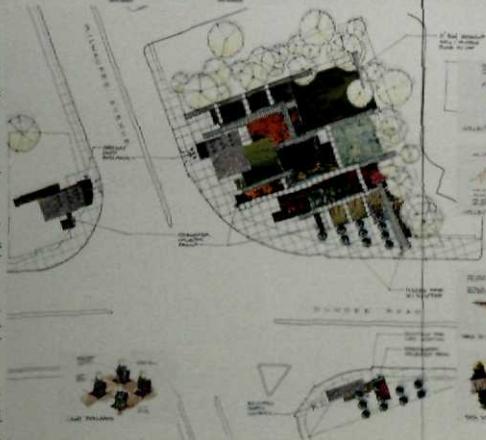

tapestry timeline

The designers sought inspiration from the historic street layout of the settlement from the 1930s. The grid layout is the result of a series of small-scale interventions, which the designers believe leads to a better urban form.



The designers sought inspiration from the historic street layout of the settlement from the 1930s. The grid layout is the result of a series of small-scale interventions, which the designers believe leads to a better urban form.



The designers sought inspiration from the historic street layout of the settlement from the 1930s. The grid layout is the result of a series of small-scale interventions, which the designers believe leads to a better urban form.



The designers sought inspiration from the historic street layout of the settlement from the 1930s. The grid layout is the result of a series of small-scale interventions, which the designers believe leads to a better urban form.

It is impossible to lift above the history of "Working the land" and to reduce the "greatness" of the American landscape to a single, simple, and unifying concept. The American landscape is a complex of many different landscapes, each with its own history and its own character. It is a landscape that has been shaped by the hands of many people, and it is a landscape that is still being shaped by the hands of many people.

"Miles and miles of prairie, slowly rising and falling, sometimes glow you the sense that something is in the process of becoming, or that the recession of a great force is imminent." — Lewis and Clark

I have never seen the plains...

"...because it takes to orient a particular reality, guiding a society's relationship to the land." — Lewis and Clark



The names of the grid is pulled with the colors and textures of the land. The grid is a map of the land, and it is a map that is being drawn by the hands of many people. The grid is a map that is being drawn by the hands of many people, and it is a map that is being drawn by the hands of many people.

The American is the essence of the American and the American is the essence of the American. The American is the essence of the American, and the American is the essence of the American. The American is the essence of the American, and the American is the essence of the American.

The great American of the future will be the one who will be able to see the land as it is, and not as it is being seen by the eyes of the American. The great American of the future will be the one who will be able to see the land as it is, and not as it is being seen by the eyes of the American.

The names of the grid are pulled with the colors and textures of the land. The grid is a map of the land, and it is a map that is being drawn by the hands of many people. The grid is a map of the land, and it is a map that is being drawn by the hands of many people.



	<p>Small text block describing the drawing.</p>	
	<p>Small text block describing the drawing.</p>	
	<p>Small text block describing the drawing.</p>	

Small text block, likely a title or introductory paragraph for the main drawing below.

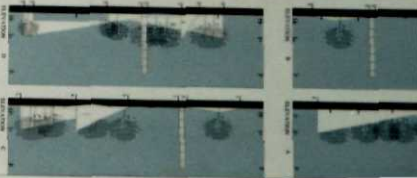
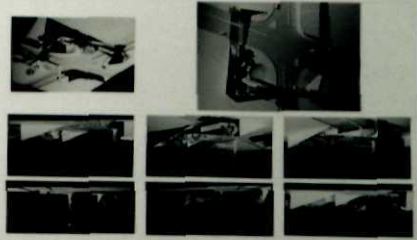
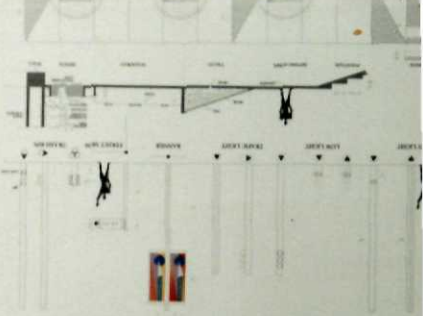
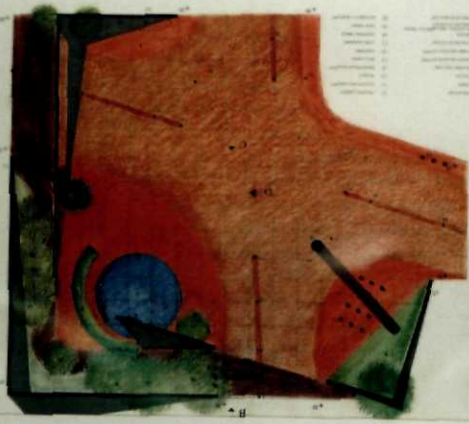

MILLENNIUM PLAZA @ THE CROSSROADS

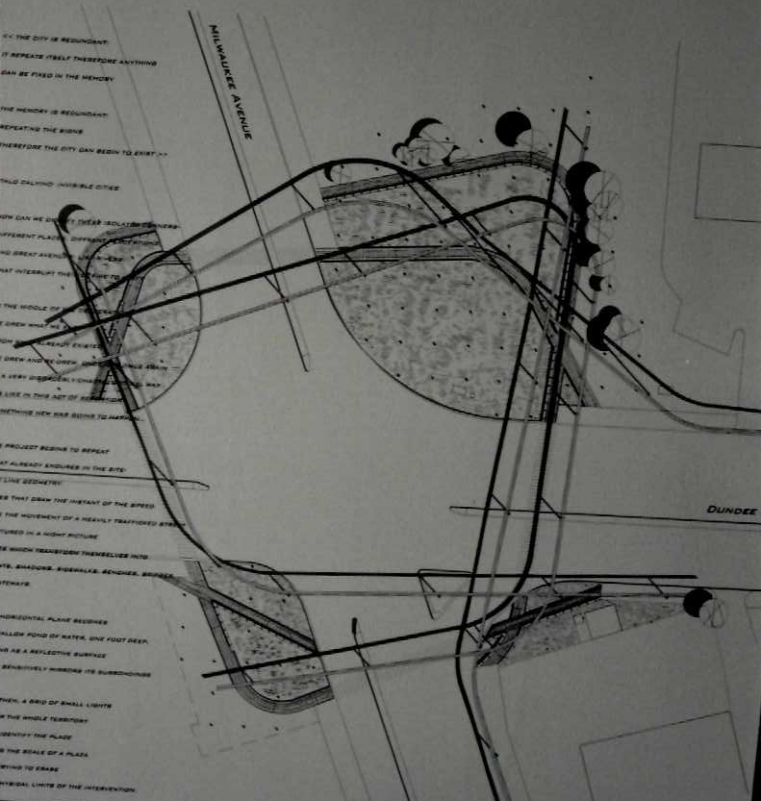

THE CITY IS REDUNDANT
 IT REPEATS ITSELF THEREFORE ANYTHING
 CAN BE FIRED IN THE MENDRY
 THE MENDRY IS REDUNDANT
 REPEATING THE SIGNS
 THEREFORE THE CITY CAN BEGIN TO EXIST...
 THIS CALLED INVISIBLE CITY
 HOW CAN WE...
 DIFFERENT PLACES...
 NO GREAT AVENUE...
 THAT INTERLUDE...
 THE MIDDLE OF...
 DREW...
 DREW...
 DREW AND...
 A VERY...
 LIKE IN THIS...
 THIS NEW...
 PROJECT...
 AT ALREADY...
 LINE...
 THAT DRAW...
 THE MOVEMENT...
 TURED IN A...
 RE MUCH...
 YTS, SHAD...
 HORIZONTAL...
 SHALLOW...
 AS A REFLECTIVE...
 SENSITIVELY...
 THEN, A...
 IN THE...
 IDENTIFY...
 THE SCALE...
 WIND TO...
 HYBRID...

CROSSROADS	SIDEWALKS	TREES	EXIST. BUILDINGS	WATER	GRID OF LIGHTS	



ork in the road"



SOUP POT INFORMATION KIOSK



POTATO MASHER BIKE RACK



SPOON BENCH AND PRAIRIE FLOWER PLANTER



SALT AND PEPPER SHAZER TRASH CONTAINERS



TEA CUP FOUNTAIN



CORK SCREW BUS STOP

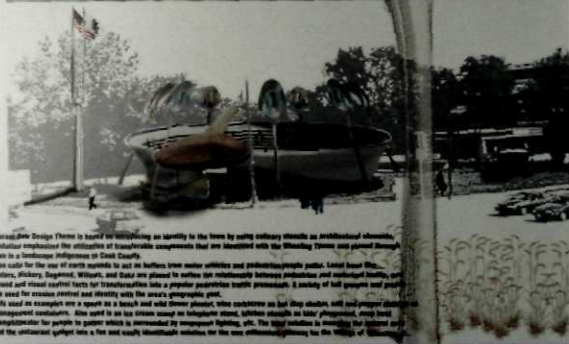
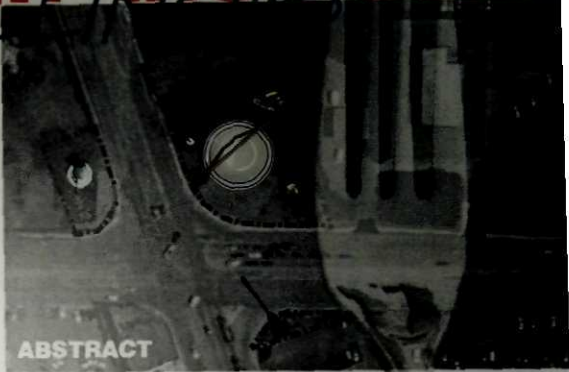

The Restaurant Design Team is honored by participating in an identity to the town by using ordinary objects as architectural elements. This presentation emphasizes the utilization of transferable components that are identified with the Shedd Park and placed throughout the town in a landscape indigenous to Cook County.

The relative scale for the use of earth elements to act as buffers from motor vehicles and pedestrian traffic is just. Local trees like Maple, Ash, Hickory, Dogwood, Walnut, and Oak are planted to reflect the relationship between pedestrian and motorist traffic, and provide shade and visual control factors for transportation into a popular pedestrian traffic area. A variety of tall grasses and prairie flowers are used for erosion control and identify with the area's geographic zone.

The elements used as examples are a spoon for a bench and salt pepper shaker, wine cooler as bus stop station, and post-processor decorative trash management containers. Also used is an egg cream stand as bike rack stand, kitchen elements as bike rack stand, and a fork as a trash can. A new application for people to gather which is increased by improved lighting, etc. The final solution is identified by the letter 'C' and the restaurant symbol into a fun and easily identifiable solution for the new entrance gateway to the Village of Shedd Park.

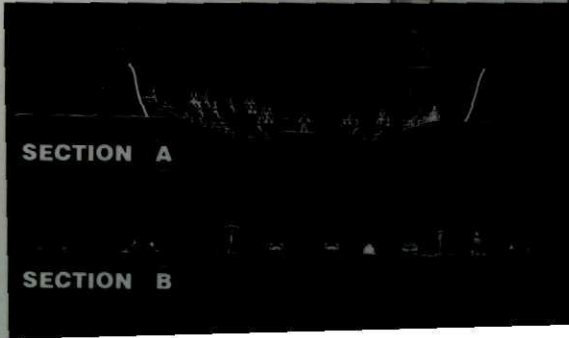

SECTION A

SECTION B

WHEELING 2000



MILLENNIUM PLAZA @ THE CROSSROADS



FIRST PHASE



SECOND PHASE

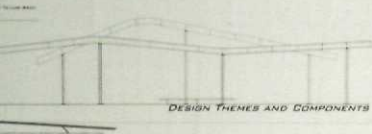

DESIGN THEMES AND COMPONENTS

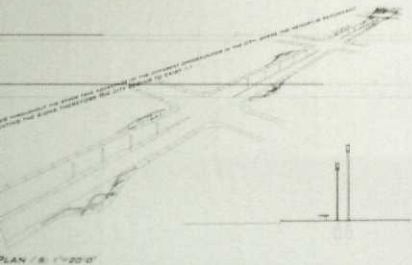

PLAN / S. 1"=20' 0"



- 1. THE CITY IS BECOMING...
- 2. BECOMING MORE...
- 3. THE PROJECT IS BECOMING...
- 4. THE PROJECT IS BECOMING...
- 5. THE PROJECT IS BECOMING...
- 6. THE PROJECT IS BECOMING...
- 7. THE PROJECT IS BECOMING...
- 8. THE PROJECT IS BECOMING...
- 9. THE PROJECT IS BECOMING...
- 10. THE PROJECT IS BECOMING...
- 11. THE PROJECT IS BECOMING...
- 12. THE PROJECT IS BECOMING...
- 13. THE PROJECT IS BECOMING...
- 14. THE PROJECT IS BECOMING...
- 15. THE PROJECT IS BECOMING...
- 16. THE PROJECT IS BECOMING...
- 17. THE PROJECT IS BECOMING...
- 18. THE PROJECT IS BECOMING...
- 19. THE PROJECT IS BECOMING...
- 20. THE PROJECT IS BECOMING...

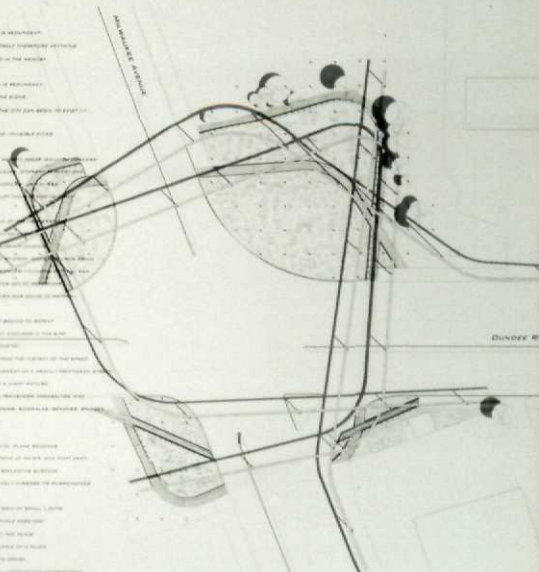

DUNDEE M...



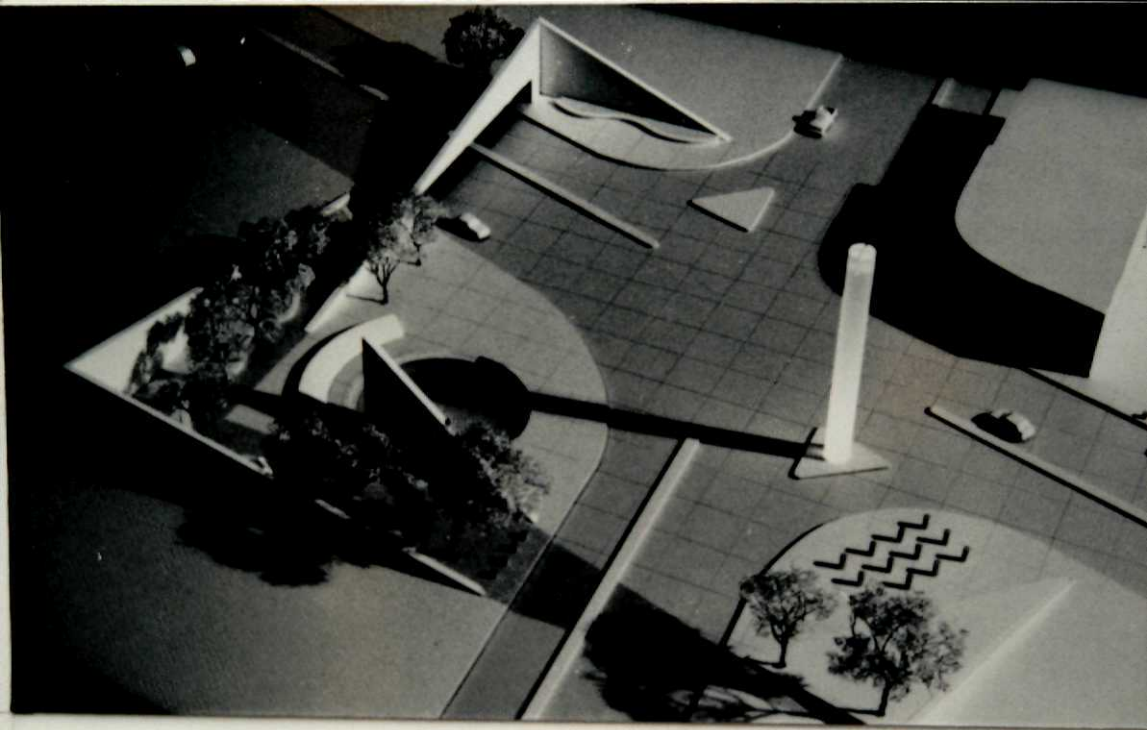

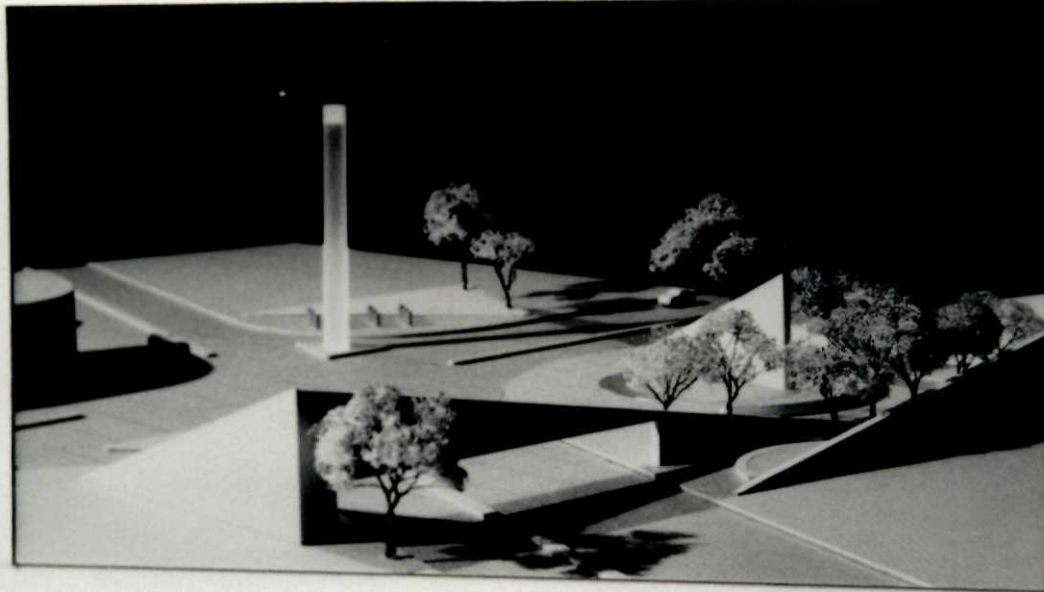

"Bear left at the fork in the road"

VILLAGE OF WHEELING, ILLINOIS

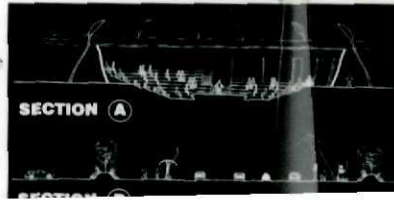
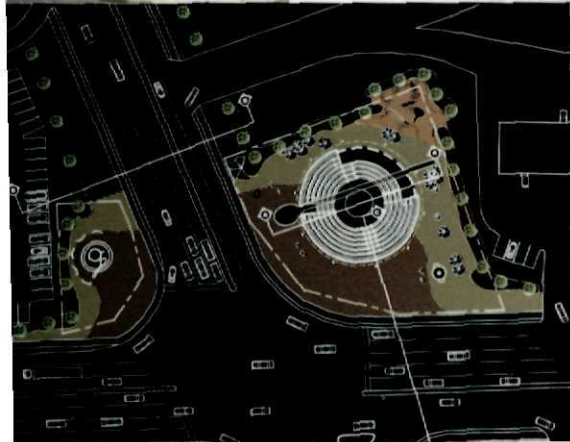

"Bear left at the fork in the road"

WHEELING, ILLINOIS



ABSTRACT



STOP FOR THE BUS



BIKE RACK AND BIKE REPAIR STATION



DOG WALKING AND PARKING



STOP FOR THE BUS



STOP FOR THE BUS



STOP FOR THE BUS



The project is a response to the need for a new public space in the heart of the city. The design is based on the idea of a "public square" that is open to all and provides a place for people to gather and interact. The design is based on the idea of a "public square" that is open to all and provides a place for people to gather and interact. The design is based on the idea of a "public square" that is open to all and provides a place for people to gather and interact.

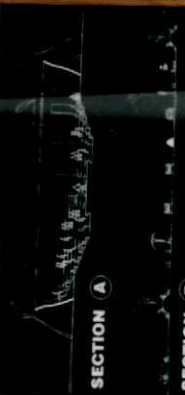

SECTION A

